

Surround Sound applications using the iCast TX-RX System

Application Diagram iCast TX-RX-SR #1

Using the iCast System and 2 Powered Speakers with a line level output Surround Sound System.

5.1 Surround Sound System [Rear side]

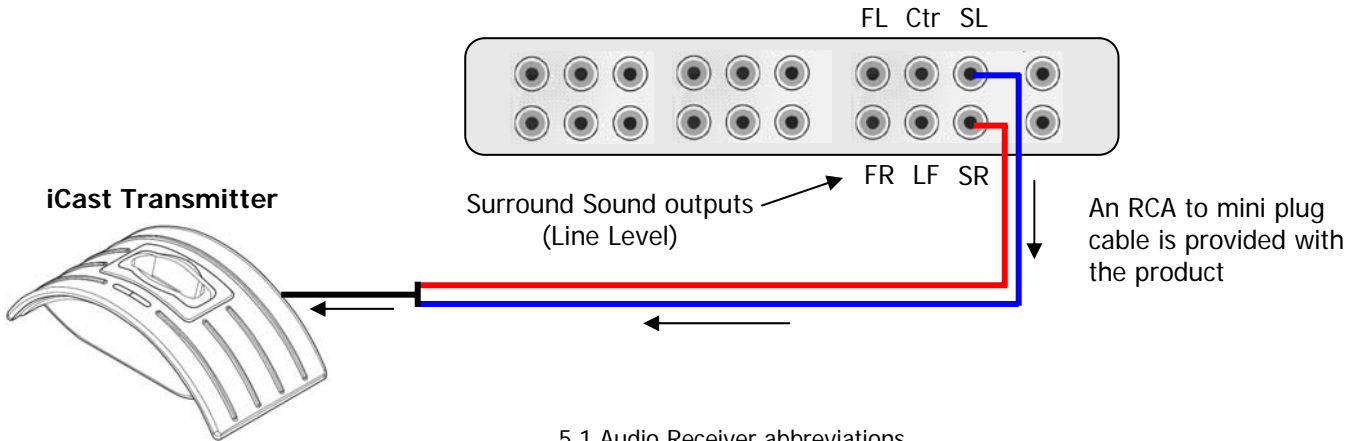

5.1 Audio Receiver abbreviations.

- SL = Surround Left channel
- SR = Surround Right channel
- Ctr = Center channel
- LF = Subwoofer channel
- FR = Front Right channel
- FL = Front Left channel

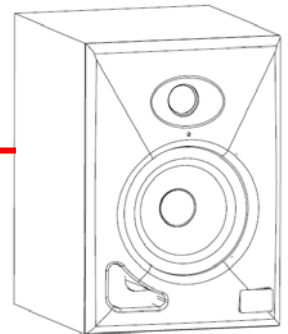
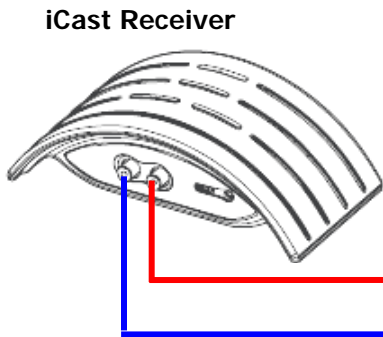

R - Surround Speaker

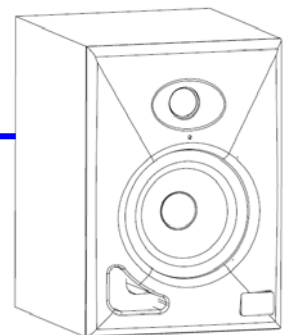

L - Surround Speaker

1 Stereo RCA cable is provided with iCast RX

Notes:
You'll have to adjust delay settings in your Home Theater equipment to compensate for the iCast's 64ms delay.

Speakers shown in this diagram are Powered Speakers.
If passive speakers are used, an amplifier between the Receiver and the Speakers will be required.

* Drawing is not to scale

Surround Sound applications using the iCast TX-RX System

Application Diagram iCast TX-RX-SR #2

Using the iCast System with a line level output Surround Sound System and an Amplifier + 2 passive speakers at the receiver end.

5.1 Surround Sound System
[Rear side]

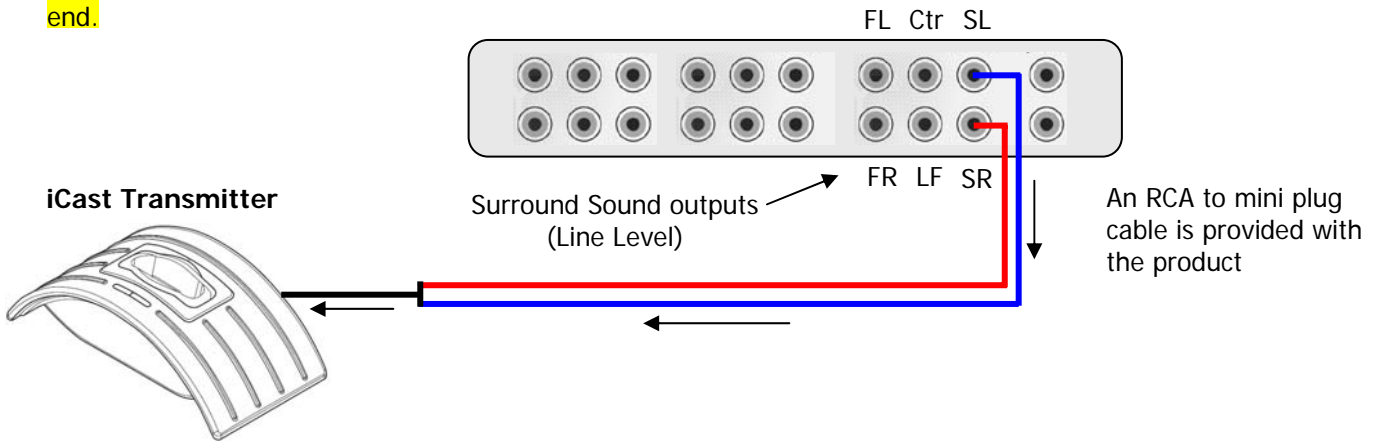

5.1 Audio Receiver abbreviations.

- SL = Surround Left channel
- SR = Surround Right channel
- Ctr = Center channel
- LF = Subwoofer channel
- FR = Front Right channel
- FL = Front Left channel

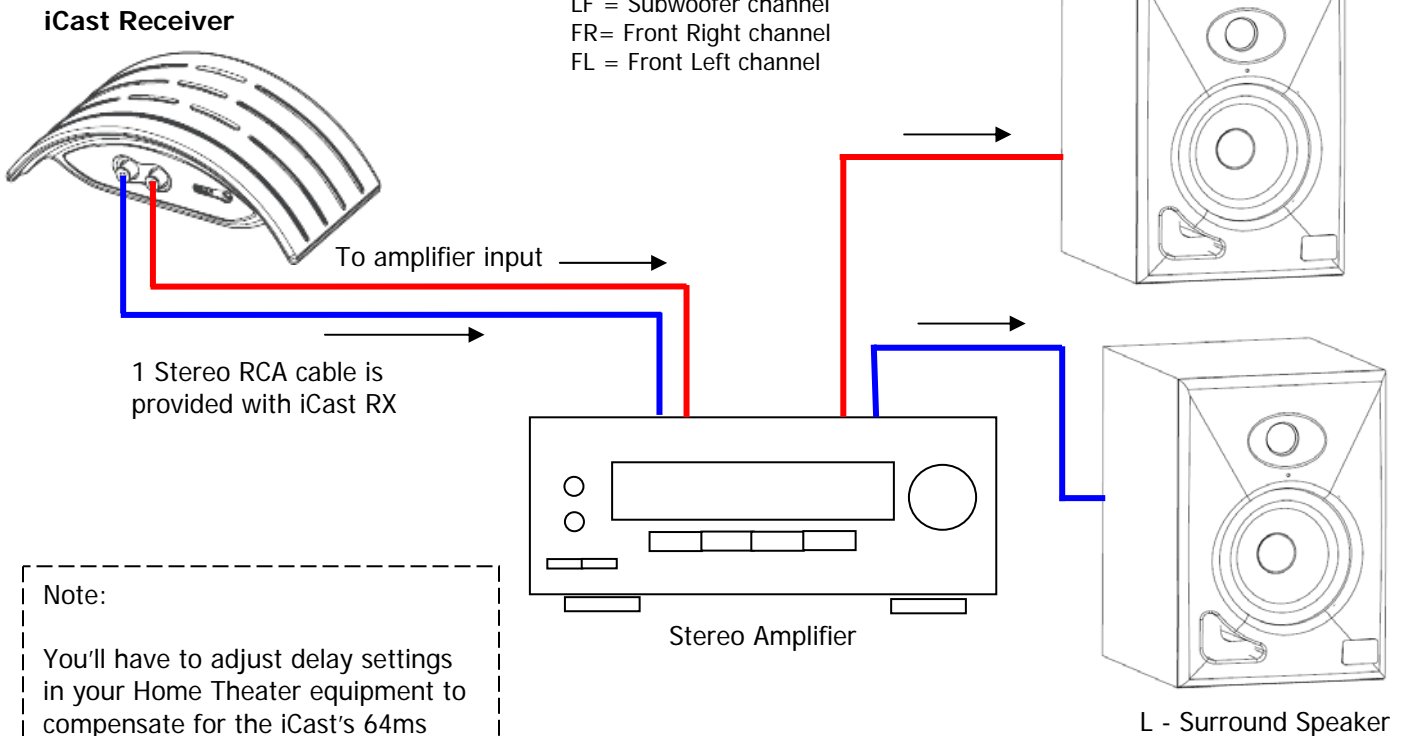

Note:

You'll have to adjust delay settings in your Home Theater equipment to compensate for the iCast's 64ms delay.

* Drawing is not to scale